

# TIME LED<sup>®</sup>

## Gallery 9W LED Under Cabinet Light (54cm)

### Installation and Operating Instructions



Read and follow instructions before operating your Under Cabinet Light  
Save this manual for future reference.

#### Package includes:

- 1 x Gallery 9W LED Under Cabinet Light (54cm)
- 1 x Manual

#### Safety:

- **This fitting is Class II: Double insulated, no earth required.**
- Before installation or maintenance, isolate the main electrical supply for the appropriate circuit at the fuse board.
- The light should be mounted onto a secure surface.
- Position lights where they will not be exposed to splashes, steam or high heat.
- When the lamp expires, the fitting must be replaced.

A qualified electrician **MUST** be consulted or employed for the installation of this light. The installation of this product must comply with the current edition of IEE wiring regulations BS7671. This light is not suitable for bathrooms or for areas of high steam or heat.

INS-780725-780732-V1

**TIME LED is part of Pitacs Limited. For customer support contact:**

Bradbourne Point, Bradbourne Drive, Tilbrook, Milton Keynes, Buckinghamshire MK7 8AT

T: +44 (0)1908 271155 F: +44 (0)1908 640017 E: [info@timeled.co.uk](mailto:info@timeled.co.uk) W: [www.timeled.co.uk](http://www.timeled.co.uk)



<b>Product Code</b>	<b>780725   780732</b>
Size (mm)	538x31x22
Watts	9W
Equivalent Wattage	72W
Lumens	800lm
Beam Angle	120°
Cable Length	1.80m

Lifespan (Hours)	25000 Hours
Colour Temp	4000K Cool White - 780725 3000K Warm White - 780732
Energy Rating	A+
Material	Mixed PC
IP Rating	IP20
Warranty	3 Years

**Installation:**

The under-cabinet light can be mounted to illuminate downward or backward depending on requirements. Under Cabinet Lights can be continuously linked up to a maximum of 10 fittings via link leads (available separately).

Connect the mains supply cable to a suitable junction box, the mains cable can be cut to length as required. Plug the mains cable into the cabinet light.

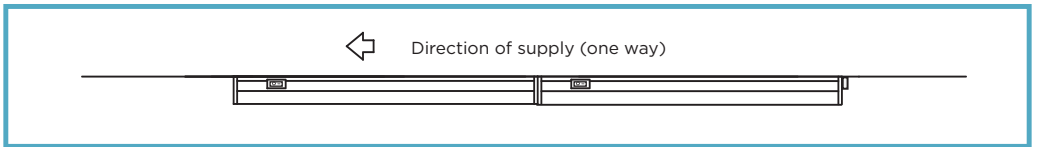
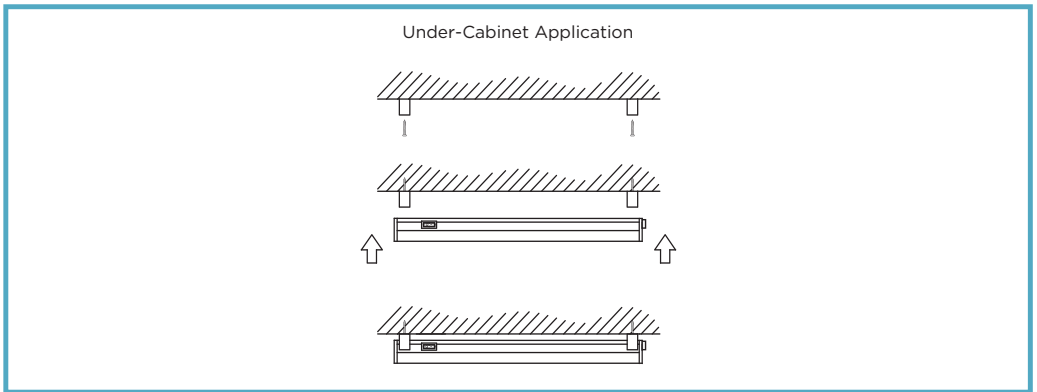

**Cleaning:**

- Do not use any chemical or abrasive cleaners.
- Clean product with a soft, dry cloth.

**Warranty:**

- This product is warranted to be free of defects in materials, design and workmanship for 3 years from the date of purchase (conditions apply, please see TIME LED website for further details). If a suspected fault should develop in this time, please contact us via the address on the front.

**Recycling Advice:**

Waste Electrical products should not be disposed of with household waste. Please recycle where facilities exist. Check with your local authority or retailer for recycling advice.

Full Technical specification available upon request. Contact [info@timeled.co.uk](mailto:info@timeled.co.uk) for PDF.