

# TIME LED<sup>®</sup>

## ULTRA PANEL - Eco

### Installation and Operating Instructions



Read and follow instructions before operating your light.  
Save this manual for future reference.

Package includes:

- 1 x Ultra Panel - Eco
- 1 x Manual

#### Safety:

- This product must be installed in accordance with the latest edition of the IEE Wiring Regulations (BS7671) and current Building Regulations. If in any doubt, consult a qualified electrician.
- Isolate mains prior to installation or maintenance.
- Check the total load on the circuit (including when this luminaire is fitted) does not exceed the rating of the circuit cable, fuse or circuit breaker.
- This product is IP20 rated and suitable for interior installations only.
- The LEDs fitted in this product are non-replaceable.
- This product is non-dimmable.

INS-783351-783368-V1

TIME LED is part of Pitacs Limited. For customer support contact:

Bradbourne Point, Bradbourne Drive, Tilbrook, Milton Keynes, Buckinghamshire MK7 8AT

T: +44 (0)1908 271155 F: +44 (0)1908 640017 E: [info@timeled.co.uk](mailto:info@timeled.co.uk) W: [www.timeled.co.uk](http://www.timeled.co.uk)



<b>Product Code</b>	<b>783351   783368</b>
Size (mm)	595X595x9
Cut Out Size (mm)	575x575
Watts	40W
Lumens	3200lm
Lamp	SMD 4014
IP Rating	IP20
Beam Angle	120°
Cable Length	10cm

Material	Aluminum + iron
Net Weight	2kg
Dimmable	No
Lifespan	30,000 hours
Voltage	220-240V
Input Frequency	50Hz
Current	AC
Colour Temp	6000K Daylight (783351) 4500K Cool White (783368)
Energy Rating	A+
Warranty	3 Years

#### Instructions for new installations:

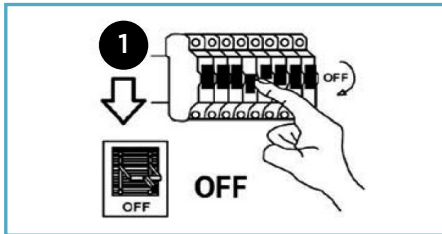

1) Ensure mains supply is switched off before installation.

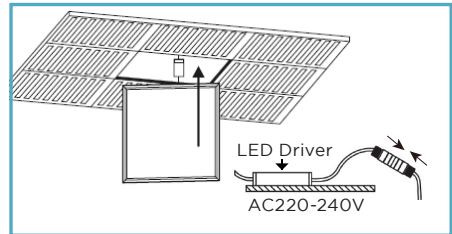

2) Place connector, driver and cable into the ceiling void. Connect the power input line with the electricity supply and power output line with the panel.

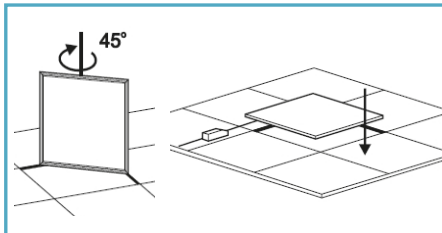

3) Install the panel into the ceiling by inserting at a 45° angle and moving to lay level and flat.

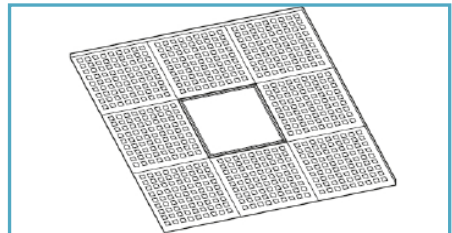

4) Once the installation is complete, restore the electricity to the panel.

#### Cleaning:

- Do not use any chemical or abrasive cleaners.
- Clean product with only a soft dry cloth.

#### Warning:

- This product must be disconnected from the circuit if subjected to any high voltage or insulation resistance testing. Irreparable damage will occur if this instruction is not followed.

#### Recycling Advice:

Waste Electrical products should not be disposed of with household waste. Please recycle where facilities exist. Check with your local authority or retailer for recycling advice.

Full Technical specification available upon request. Contact [info@timeled.co.uk](mailto:info@timeled.co.uk) for PDF.

# TIME LED®

## ULTRA PANEL - Eco